

# LONG ISLAND CITY

## 27th STREET SWC 41st AVENUE

### RETAIL SPACE IN NEW DEVELOPMENT

**LOCATION:**

41-04 27th Street, SWC 41st Avenue  
 Long Island City, Queens, NY 11101

**RETAIL SPACE SIZE:**

- 1) 1,175 sf (plus 293 sf storage) corner.
- 2) LIC Bagel Café featuring Peet's Coffee
- 3 & 4) NYC Smiling Dentist
- 5) Lower Level: 3) 973 sf,

**DESCRIPTION:**

- Condo Development
- 32 Residential Units
- New Construction
- HVAC

**ZONING:** M1-5/R7-3.



**PRICE:** TBD      **RE TAX:** \$3:40/SF, tax abatement in place. **CAM:** \$7:93/SF

**NEIGHBORHOOD:** Long Island City is one of the fastest growing neighborhoods in New York City. Dense Residential Zoning allows for hi-rise apartment development. The site is located one block from the very busy Queensboro Plaza Subway Stop (N, Q and 7 lines with over 3.7 million riders per year) and three blocks from the busy Queens Plaza Subway Stop (E, M and R lines with over 3 million riders per year). Long Island City is also home to many businesses (Jet Blue and Metlife are across the street) with a tremendous daytime population.

**NOTE:** Excellent corner location in a rapidly growing neighborhood!

2018	1/4 Mile	1/2 Mile	1 Mile
Estimated Population	7,740	21,667	84,109
Estimated Median HH Income	\$77,972	\$59,047	\$73,882

**Subway Lines**



This property is offered subject to availability, errors, omissions, or changes in price or terms without notice. ID #3047



*For more information and inspection, contact*  
**Metro Commercial & Business Brokers, Inc.**  
 425 Linda Drive, East Meadow, NY 11554  
[www.metrocbb.com](http://www.metrocbb.com)



John R. Wilmarth  
 (516) 640-5440 [john@metrocb.com](mailto:john@metrocb.com)

Gerry Dantone  
 (631) 623-6914 [metrocb@aol.com](mailto:metrocb@aol.com)

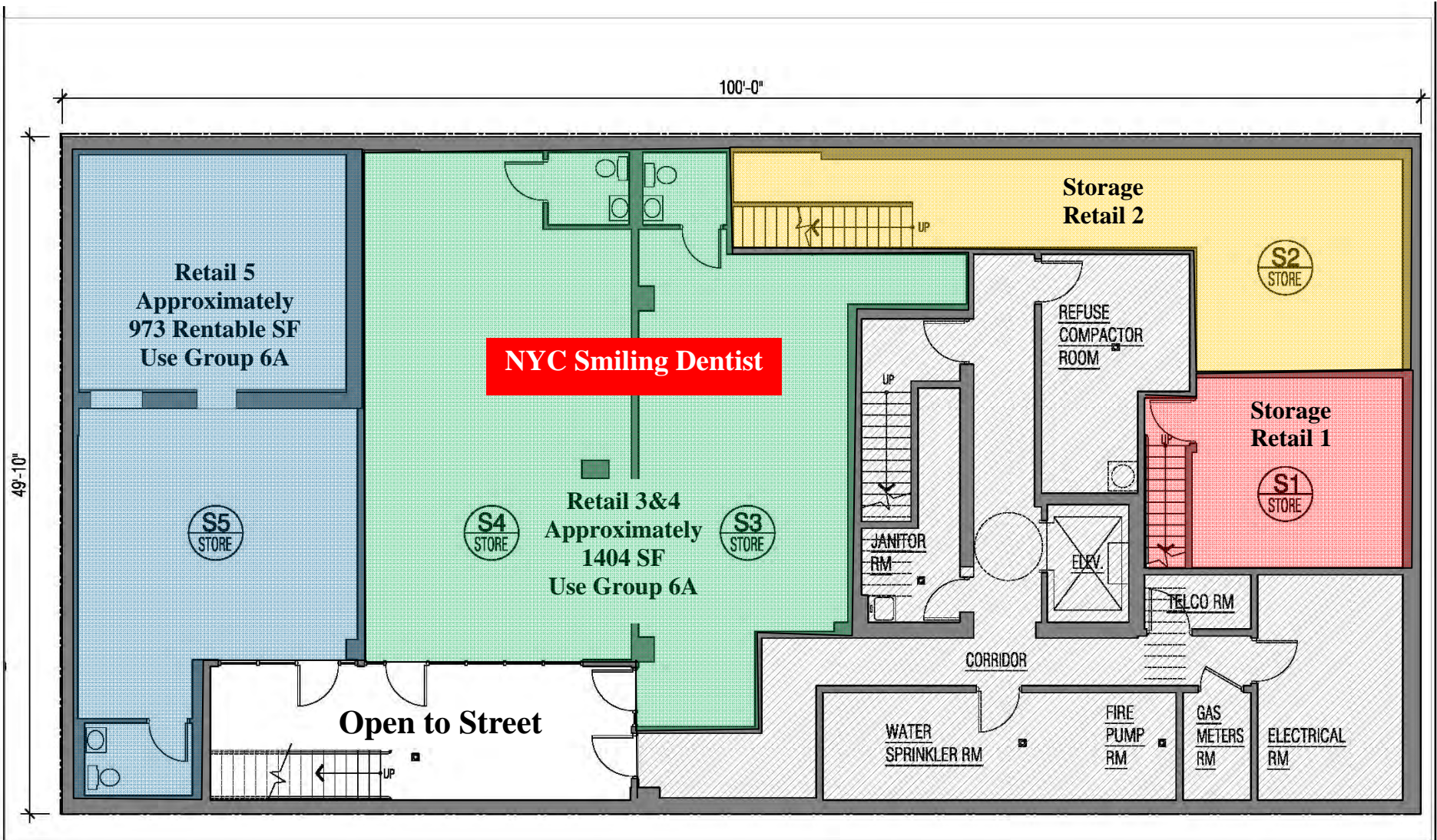

*For more information and inspection, contact*  
**Metro Commercial & Business Brokers, Inc.**  
 425 Linda Drive, East Meadow, NY 11554  
[www.metrocbb.com](http://www.metrocbb.com)

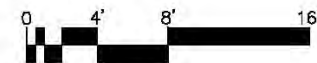

John R. Wilmarth  
 (516) 640-5440 [john@metrocbb.com](mailto:john@metrocbb.com)

Gerry Dantone  
 (631) 623-6914 [metrocb@aol.com](mailto:metrocb@aol.com)

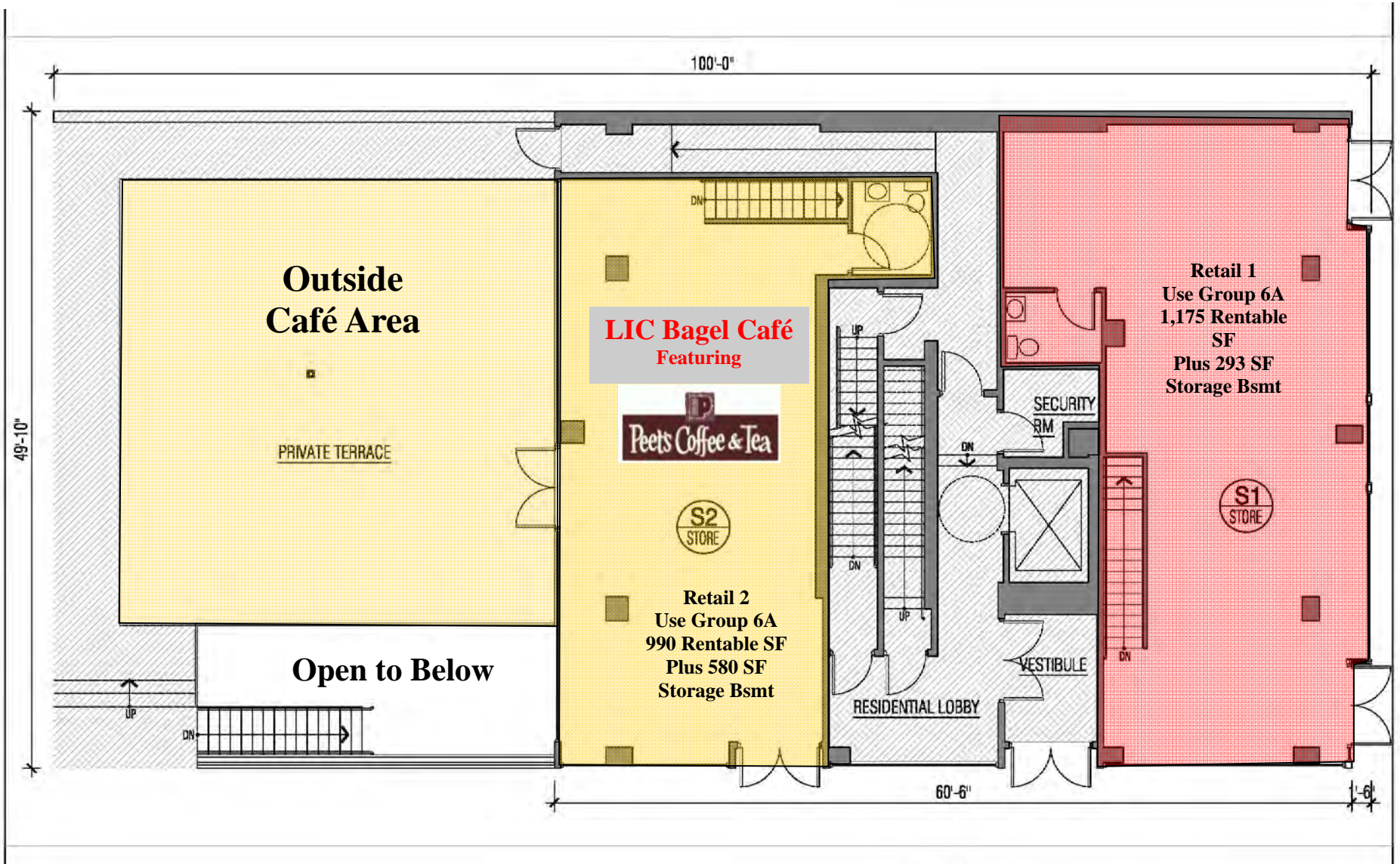

*For more information and inspection, contact*  
**Metro Commercial & Business Brokers, Inc.**  
425 Linda Drive, East Meadow, NY 11554  
[www.metrocbb.com](http://www.metrocbb.com)

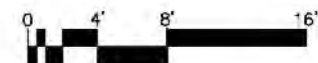

John R. Wilmarth  
(516) 640-5440 [john@metrocb.com](mailto:john@metrocb.com)

Gerry Dantone  
(631) 623-6914 [metrocb@aol.com](mailto:metrocb@aol.com)

# 41-04 27th Street, Long Island City, Queens, NY 11101

Queens Plaza North Side  
New Development



*For more information and inspection, contact*  
**Metro Commercial & Business Brokers, Inc.**  
425 Linda Drive, East Meadow, NY 11554  
[www.metrocbb.com](http://www.metrocbb.com)

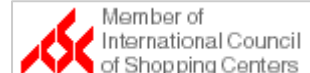

John R. Wilmarth  
(516) 640-5440 [john@metrocb.com](mailto:john@metrocb.com)

Gerry Dantone  
(631) 623-6914 [metrocb@aol.com](mailto:metrocb@aol.com)

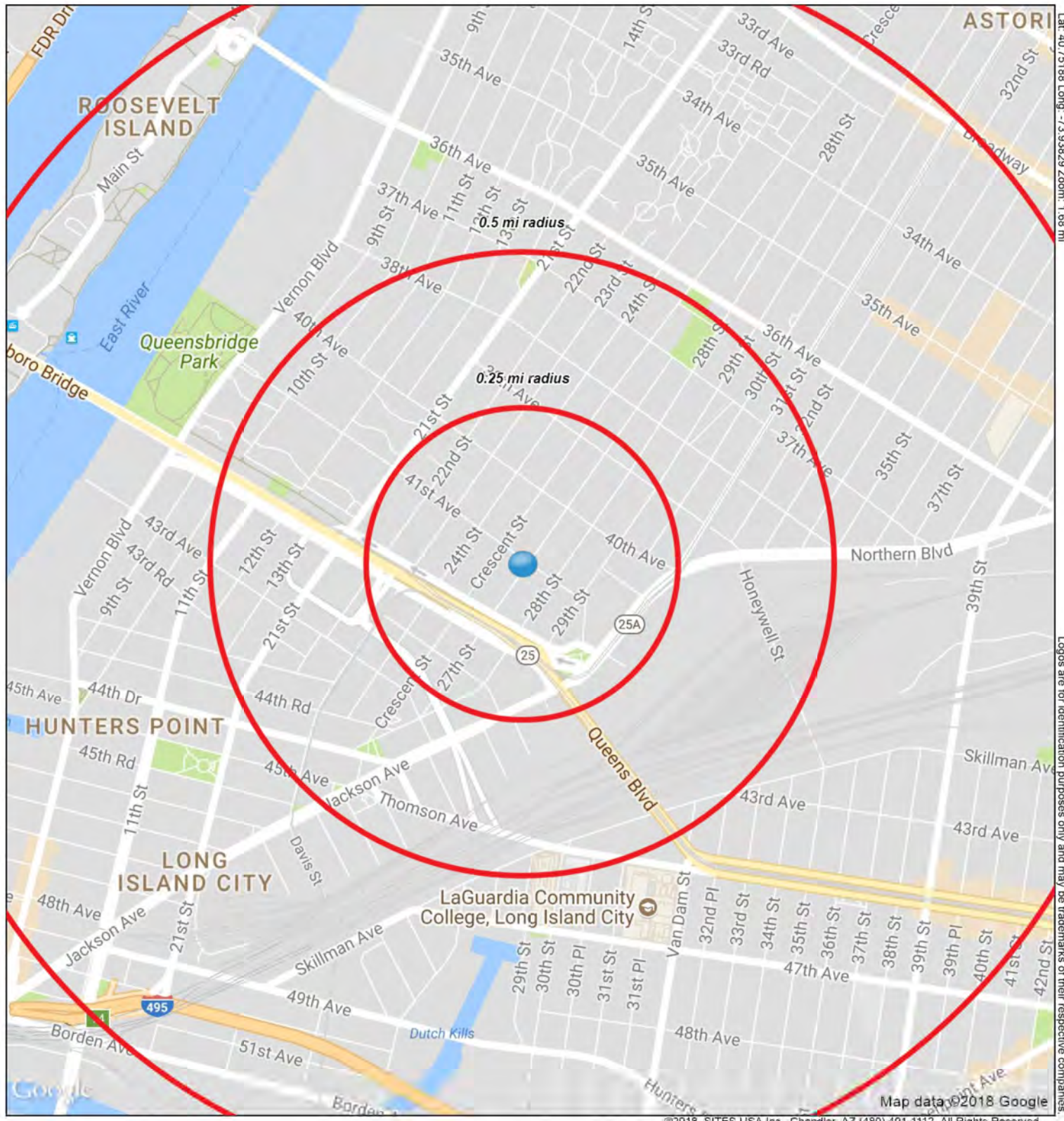

Lat: 40.75188 Long: -73.93829 Zoom: 1.68 mi  
Logos are for identification purposes only and may be trademarks of their respective companies.

**41-04 27th St**

**Long Island City, NY 11101**



May 2018

Metro Commercial & Business Brokers, Inc.

This map was produced using data from private and government sources deemed to be reliable. The information herein is provided without representation or warranty.

# COMPLETE PROFILE

2000-2010 Census, 2018 Estimates with 2023 Projections

Calculated using Weighted Block Centroid from Block Groups



Metro Commercial & Business Brokers, Inc.

Lat/Lon: 40.7518/-73.9385

RFULL9

## 41-04 27th St

### Long Island City, NY 11101

#### Population

	0.25 mi radius		0.5 mi radius		1 mi radius	
Estimated Population (2018)	7,740		21,657		84,109	
Projected Population (2023)	7,737		21,801		85,120	
Census Population (2010)	2,154		13,297		67,014	
Census Population (2000)	2,018		12,594		62,405	
Projected Annual Growth (2018-2023)	-3	-	144	0.1%	1,011	0.2%
Historical Annual Growth (2010-2018)	5,586	32.4%	8,360	7.9%	17,095	3.2%
Historical Annual Growth (2000-2010)	136	0.7%	703	0.6%	4,609	0.7%
Estimated Population Density (2018)	39,486 <i>psm</i>		27,618 <i>psm</i>		26,785 <i>psm</i>	
Trade Area Size	0.2 <i>sq mi</i>		0.8 <i>sq mi</i>		3.1 <i>sq mi</i>	

#### Households

Estimated Households (2018)	3,021		8,454		35,747	
Projected Households (2023)	3,112		8,758		37,197	
Census Households (2010)	808		5,076		28,056	
Census Households (2000)	617		4,426		24,193	
Projected Annual Growth (2018-2023)	90	0.6%	304	0.7%	1,449	0.8%
Historical Annual Change (2000-2018)	2,404	21.6%	4,028	5.1%	11,554	2.7%

#### Average Household Income

Estimated Average Household Income (2018)	\$63,302		\$57,416		\$84,962	
Projected Average Household Income (2023)	\$74,042		\$67,513		\$101,116	
Census Average Household Income (2010)	\$69,894		\$43,489		\$60,354	
Census Average Household Income (2000)	\$47,098		\$34,749		\$43,242	
Projected Annual Change (2018-2023)	\$10,740	3.4%	\$10,098	3.5%	\$16,155	3.8%
Historical Annual Change (2000-2018)	\$16,205	1.9%	\$22,666	3.6%	\$41,720	5.4%

#### Median Household Income

Estimated Median Household Income (2018)	\$77,972		\$59,047		\$73,882	
Projected Median Household Income (2023)	\$88,192		\$66,892		\$85,077	
Census Median Household Income (2010)	\$63,404		\$35,203		\$47,760	
Census Median Household Income (2000)	\$31,858		\$23,912		\$33,507	
Projected Annual Change (2018-2023)	\$10,220	2.6%	\$7,846	2.7%	\$11,196	3.0%
Historical Annual Change (2000-2018)	\$46,114	8.0%	\$35,135	8.2%	\$40,375	6.7%

#### Per Capita Income

Estimated Per Capita Income (2018)	\$24,729		\$22,432		\$36,286	
Projected Per Capita Income (2023)	\$29,794		\$27,141		\$44,361	
Census Per Capita Income (2010)	\$26,212		\$16,602		\$25,267	
Census Per Capita Income (2000)	\$12,855		\$12,446		\$16,763	
Projected Annual Change (2018-2023)	\$5,065	4.1%	\$4,709	4.2%	\$8,075	4.5%
Historical Annual Change (2000-2018)	\$11,875	5.1%	\$9,986	4.5%	\$19,523	6.5%
Estimated Average Household Net Worth (2018)	\$1,146,176		\$842,881		\$971,045	

This report was produced using data from private and government sources deemed to be reliable. The information herein is provided without representation or warranty.

# COMPLETE PROFILE

2000-2010 Census, 2018 Estimates with 2023 Projections

Calculated using Weighted Block Centroid from Block Groups



Metro Commercial & Business Brokers, Inc.

Lat/Lon: 40.7518/-73.9385

RFULL9

41-04 27th St Long Island City, NY 11101	0.25 mi radius		0.5 mi radius		1 mi radius	
<b>Race and Ethnicity</b>						
Total Population (2018)	7,740		21,657		84,109	
White (2018)	3,796	49.0%	8,074	37.3%	38,560	45.8%
Black or African American (2018)	1,543	19.9%	6,177	28.5%	15,673	18.6%
American Indian or Alaska Native (2018)	45	0.6%	165	0.8%	434	0.5%
Asian (2018)	804	10.4%	3,266	15.1%	16,843	20.0%
Hawaiian or Pacific Islander (2018)	3	-	11	-	86	0.1%
Other Race (2018)	1,137	14.7%	2,952	13.6%	9,104	10.8%
Two or More Races (2018)	413	5.3%	1,014	4.7%	3,409	4.1%
Population < 18 (2018)	1,434	18.5%	4,484	20.7%	15,115	18.0%
White Not Hispanic	233	16.3%	542	12.1%	3,325	22.0%
Black or African American	238	16.6%	1,309	29.2%	3,050	20.2%
Asian	130	9.1%	595	13.3%	2,959	19.6%
Other Race Not Hispanic	37	2.6%	125	2.8%	643	4.3%
Hispanic	795	55.5%	1,912	42.6%	5,139	34.0%
Not Hispanic or Latino Population (2018)	4,335	56.0%	13,260	61.2%	59,445	70.7%
Not Hispanic White	2,312	53.3%	4,481	33.8%	27,337	46.0%
Not Hispanic Black or African American	1,022	23.6%	4,967	37.5%	13,084	22.0%
Not Hispanic American Indian or Alaska Native	20	0.5%	56	0.4%	151	0.3%
Not Hispanic Asian	712	16.4%	3,079	23.2%	16,309	27.4%
Not Hispanic Hawaiian or Pacific Islander	2	0.1%	10	0.1%	74	0.1%
Not Hispanic Other Race	47	1.1%	176	1.3%	654	1.1%
Not Hispanic Two or More Races	220	5.1%	492	3.7%	1,837	3.1%
Hispanic or Latino Population (2018)	3,405	44.0%	8,397	38.8%	24,664	29.3%
Hispanic White	1,484	43.6%	3,592	42.8%	11,223	45.5%
Hispanic Black or African American	521	15.3%	1,210	14.4%	2,589	10.5%
Hispanic American Indian or Alaska Native	26	0.8%	110	1.3%	283	1.1%
Hispanic Asian	92	2.7%	187	2.2%	535	2.2%
Hispanic Hawaiian or Pacific Islander	-	-	1	-	12	-
Hispanic Other Race	1,090	32.0%	2,776	33.1%	8,450	34.3%
Hispanic Two or More Races	193	5.7%	522	6.2%	1,572	6.4%
Not Hispanic or Latino Population (2010)	1,304	60.5%	8,397	63.1%	47,180	70.4%
Hispanic or Latino Population (2010)	850	39.5%	4,900	36.9%	19,834	29.6%
Not Hispanic or Latino Population (2000)	920	45.6%	7,932	63.0%	41,957	67.2%
Hispanic or Latino Population (2000)	1,098	54.4%	4,662	37.0%	20,448	32.8%
Not Hispanic or Latino Population (2023)	4,302	55.6%	13,249	60.8%	59,365	69.7%
Hispanic or Latino Population (2023)	3,435	44.4%	8,552	39.2%	25,754	30.3%
Projected Annual Growth (2018-2023)	30	0.2%	155	0.4%	1,091	0.9%
Historical Annual Growth (2000-2010)	-248	-2.3%	238	0.5%	-614	-0.3%

This report was produced using data from private and government sources deemed to be reliable. The information herein is provided without representation or warranty.

# COMPLETE PROFILE

2000-2010 Census, 2018 Estimates with 2023 Projections

Calculated using Weighted Block Centroid from Block Groups



Metro Commercial & Business Brokers, Inc.

Lat/Lon: 40.7518/-73.9385

RFULL9

## 41-04 27th St

### Long Island City, NY 11101

0.25 mi radius      0.5 mi radius      1 mi radius

#### Total Age Distribution (2018)

	0.25 mi radius	0.5 mi radius	1 mi radius
Total Population	7,740	21,657	84,109
Age Under 5 Years	475 6.1%	1,340 6.2%	4,800 5.7%
Age 5 to 9 Years	409 5.3%	1,256 5.8%	4,198 5.0%
Age 10 to 14 Years	353 4.6%	1,190 5.5%	3,967 4.7%
Age 15 to 19 Years	348 4.5%	1,211 5.6%	3,804 4.5%
Age 20 to 24 Years	534 6.9%	1,453 6.7%	5,240 6.2%
Age 25 to 29 Years	833 10.8%	2,121 9.8%	9,104 10.8%
Age 30 to 34 Years	814 10.5%	1,923 8.9%	8,593 10.2%
Age 35 to 39 Years	687 8.9%	1,693 7.8%	7,051 8.4%
Age 40 to 44 Years	534 6.9%	1,476 6.8%	5,795 6.9%
Age 45 to 49 Years	513 6.6%	1,393 6.4%	5,434 6.5%
Age 50 to 54 Years	449 5.8%	1,331 6.1%	5,086 6.0%
Age 55 to 59 Years	436 5.6%	1,295 6.0%	5,082 6.0%
Age 60 to 64 Years	403 5.2%	1,212 5.6%	4,715 5.6%
Age 65 to 69 Years	289 3.7%	898 4.1%	3,741 4.4%
Age 70 to 74 Years	247 3.2%	741 3.4%	2,699 3.2%
Age 75 to 79 Years	161 2.1%	437 2.0%	1,862 2.2%
Age 80 to 84 Years	118 1.5%	350 1.6%	1,379 1.6%
Age 85 Years or Over	136 1.8%	336 1.6%	1,558 1.9%
Median Age	34.7	35.2	36.1
Age 19 Years or Less	1,586 20.5%	4,998 23.1%	16,769 19.9%
Age 20 to 64 Years	5,204 67.2%	13,897 64.2%	56,101 66.7%
Age 65 Years or Over	951 12.3%	2,762 12.8%	11,239 13.4%

#### Female Age Distribution (2018)

	0.25 mi radius	0.5 mi radius	1 mi radius
Female Population	3,941 50.9%	11,340 52.4%	43,549 51.8%
Age Under 5 Years	246 6.2%	666 5.9%	2,347 5.4%
Age 5 to 9 Years	193 4.9%	577 5.1%	2,067 4.7%
Age 10 to 14 Years	184 4.7%	562 5.0%	1,929 4.4%
Age 15 to 19 Years	160 4.1%	583 5.1%	1,809 4.2%
Age 20 to 24 Years	244 6.2%	703 6.2%	2,657 6.1%
Age 25 to 29 Years	416 10.5%	1,113 9.8%	4,711 10.8%
Age 30 to 34 Years	387 9.8%	953 8.4%	4,268 9.8%
Age 35 to 39 Years	337 8.6%	856 7.5%	3,445 7.9%
Age 40 to 44 Years	254 6.4%	769 6.8%	2,805 6.4%
Age 45 to 49 Years	241 6.1%	721 6.4%	2,676 6.1%
Age 50 to 54 Years	217 5.5%	680 6.0%	2,587 5.9%
Age 55 to 59 Years	233 5.9%	727 6.4%	2,731 6.3%
Age 60 to 64 Years	241 6.1%	721 6.4%	2,673 6.1%
Age 65 to 69 Years	171 4.3%	538 4.7%	2,202 5.1%
Age 70 to 74 Years	145 3.7%	442 3.9%	1,552 3.6%
Age 75 to 79 Years	104 2.6%	288 2.5%	1,150 2.6%
Age 80 to 84 Years	80 2.0%	227 2.0%	872 2.0%
Age 85 Years or Over	88 2.2%	214 1.9%	1,066 2.4%
Female Median Age	36.1	37.1	37.3
Age 19 Years or Less	784 19.9%	2,388 21.1%	8,153 18.7%
Age 20 to 64 Years	2,570 65.2%	7,243 63.9%	28,553 65.6%
Age 65 Years or Over	588 14.9%	1,709 15.1%	6,843 15.7%

This report was produced using data from private and government sources deemed to be reliable. The information herein is provided without representation or warranty.



# COMPLETE PROFILE

2000-2010 Census, 2018 Estimates with 2023 Projections

Calculated using Weighted Block Centroid from Block Groups



Metro Commercial & Business Brokers, Inc.

Lat/Lon: 40.7518/-73.9385

RFULL9

## 41-04 27th St

### Long Island City, NY 11101

0.25 mi radius      0.5 mi radius      1 mi radius

#### Male Age Distribution (2018)

	0.25 mi radius	0.5 mi radius	1 mi radius
Male Population	3,799 49.1%	10,317 47.6%	40,560 48.2%
Age Under 5 Years	229 6.0%	674 6.5%	2,452 6.0%
Age 5 to 9 Years	216 5.7%	679 6.6%	2,131 5.3%
Age 10 to 14 Years	169 4.4%	628 6.1%	2,037 5.0%
Age 15 to 19 Years	188 4.9%	629 6.1%	1,995 4.9%
Age 20 to 24 Years	290 7.6%	750 7.3%	2,584 6.4%
Age 25 to 29 Years	418 11.0%	1,009 9.8%	4,393 10.8%
Age 30 to 34 Years	427 11.2%	970 9.4%	4,325 10.7%
Age 35 to 39 Years	350 9.2%	837 8.1%	3,607 8.9%
Age 40 to 44 Years	280 7.4%	707 6.8%	2,990 7.4%
Age 45 to 49 Years	272 7.2%	672 6.5%	2,757 6.8%
Age 50 to 54 Years	232 6.1%	651 6.3%	2,499 6.2%
Age 55 to 59 Years	203 5.4%	568 5.5%	2,351 5.8%
Age 60 to 64 Years	162 4.3%	491 4.8%	2,042 5.0%
Age 65 to 69 Years	118 3.1%	360 3.5%	1,539 3.8%
Age 70 to 74 Years	102 2.7%	299 2.9%	1,147 2.8%
Age 75 to 79 Years	57 1.5%	149 1.4%	712 1.8%
Age 80 to 84 Years	38 1.0%	123 1.2%	506 1.2%
Age 85 Years or Over	48 1.3%	122 1.2%	492 1.2%
Male Median Age	33.6	32.6	34.5
Age 19 Years or Less	802 21.1%	2,610 25.3%	8,616 21.2%
Age 20 to 64 Years	2,634 69.3%	6,654 64.5%	27,548 67.9%
Age 65 Years or Over	363 9.6%	1,053 10.2%	4,396 10.8%

#### Males per 100 Females (2018)

	0.25 mi radius	0.5 mi radius	1 mi radius
Overall Comparison	96	91	93
Age Under 5 Years	93 48.2%	101 50.3%	104 51.1%
Age 5 to 9 Years	112 52.7%	118 54.1%	103 50.8%
Age 10 to 14 Years	92 47.9%	112 52.8%	106 51.4%
Age 15 to 19 Years	117 53.9%	108 51.9%	110 52.4%
Age 20 to 24 Years	119 54.3%	107 51.6%	97 49.3%
Age 25 to 29 Years	100 50.1%	91 47.6%	93 48.3%
Age 30 to 34 Years	110 52.4%	102 50.4%	101 50.3%
Age 35 to 39 Years	104 50.9%	98 49.4%	105 51.2%
Age 40 to 44 Years	110 52.5%	92 47.9%	107 51.6%
Age 45 to 49 Years	113 53.1%	93 48.2%	103 50.7%
Age 50 to 54 Years	107 51.6%	96 48.9%	97 49.1%
Age 55 to 59 Years	87 46.6%	78 43.8%	86 46.3%
Age 60 to 64 Years	67 40.3%	68 40.5%	76 43.3%
Age 65 to 69 Years	69 40.8%	67 40.1%	70 41.1%
Age 70 to 74 Years	71 41.4%	68 40.4%	74 42.5%
Age 75 to 79 Years	55 35.5%	52 34.1%	62 38.2%
Age 80 to 84 Years	47 31.9%	54 35.1%	58 36.7%
Age 85 Years or Over	55 35.5%	57 36.3%	46 31.6%
Age 19 Years or Less	102 50.6%	109 52.2%	106 51.4%
Age 20 to 39 Years	107 51.7%	98 49.6%	99 49.7%
Age 40 to 64 Years	97 49.2%	85 46.0%	94 48.4%
Age 65 Years or Over	62 38.2%	62 38.1%	64 39.1%

This report was produced using data from private and government sources deemed to be reliable. The information herein is provided without representation or warranty.

# COMPLETE PROFILE

2000-2010 Census, 2018 Estimates with 2023 Projections

Calculated using Weighted Block Centroid from Block Groups



Metro Commercial & Business Brokers, Inc.

Lat/Lon: 40.7518/-73.9385

RFULL9

## 41-04 27th St

### Long Island City, NY 11101

	0.25 mi radius	0.5 mi radius	1 mi radius
<b>Household Type (2018)</b>			
Total Households	3,021	8,454	35,747
Households with Children	682 22.6%	2,325 27.5%	7,918 22.2%
Average Household Size	2.6	2.6	2.3
Household Density per Square Mile	15,414	10,781	11,384
Population Family	5,524 71.4%	16,452 76.0%	58,380 69.4%
Population Non-Family	2,202 28.5%	5,168 23.9%	23,996 28.5%
Population Group Quarters	13 0.2%	36 0.2%	1,733 2.1%
Family Households	1,504 49.8%	4,666 55.2%	18,094 50.6%
Married Couple Households	872 58.0%	2,253 48.3%	10,967 60.6%
Other Family Households	631 42.0%	2,413 51.7%	7,127 39.4%
Family Households with Children	679 45.2%	2,316 49.6%	7,879 43.5%
Married Couple with Children	388 57.1%	1,008 43.5%	4,421 56.1%
Other Family Households with Children	291 42.9%	1,308 56.5%	3,458 43.9%
Family Households No Children	825 54.8%	2,350 50.4%	10,215 56.5%
Married Couple No Children	484 58.7%	1,245 53.0%	6,546 64.1%
Other Family Households No Children	340 41.3%	1,105 47.0%	3,669 35.9%
Non-Family Households	1,518 50.2%	3,788 44.8%	17,653 49.4%
Non-Family Households with Children	3 0.2%	8 0.2%	39 0.2%
Non-Family Households No Children	1,515 99.8%	3,780 99.8%	17,614 99.8%
Average Family Household Size	3.7	3.5	3.2
Average Family Income	\$65,639	\$55,390	\$92,182
Median Family Income	\$102,329	\$69,969	\$87,415
Average Non-Family Household Size	1.5	1.4	1.4
<b>Marital Status (2018)</b>			
Population Age 15 Years or Over	6,503	17,870	71,144
Never Married	3,623 55.7%	9,505 53.2%	33,755 47.4%
Currently Married	1,962 30.2%	5,099 28.5%	23,914 33.6%
Previously Married	917 14.1%	3,266 18.3%	13,475 18.9%
Separated	471 51.4%	1,394 42.7%	4,861 36.1%
Widowed	97 10.6%	569 17.4%	3,052 22.6%
Divorced	349 38.0%	1,303 39.9%	5,562 41.3%
<b>Educational Attainment (2018)</b>			
Adult Population Age 25 Years or Over	5,620	15,206	62,100
Elementary (Grade Level 0 to 8)	279 5.0%	1,558 10.2%	4,518 7.3%
Some High School (Grade Level 9 to 11)	311 5.5%	1,427 9.4%	4,282 6.9%
High School Graduate	1,327 23.6%	3,836 25.2%	12,355 19.9%
Some College	580 10.3%	1,894 12.5%	7,102 11.4%
Associate Degree Only	242 4.3%	693 4.6%	3,586 5.8%
Bachelor Degree Only	1,669 29.7%	3,334 21.9%	16,727 26.9%
Graduate Degree	1,214 21.6%	2,464 16.2%	13,531 21.8%
Any College (Some College or Higher)	3,704 65.9%	8,385 55.1%	40,945 65.9%
College Degree + (Bachelor Degree or Higher)	2,882 51.3%	5,798 38.1%	30,258 48.7%

This report was produced using data from private and government sources deemed to be reliable. The information herein is provided without representation or warranty.

# COMPLETE PROFILE

2000-2010 Census, 2018 Estimates with 2023 Projections

Calculated using Weighted Block Centroid from Block Groups



Metro Commercial & Business Brokers, Inc.

Lat/Lon: 40.7518/-73.9385

RFULL9

## 41-04 27th St

### Long Island City, NY 11101

0.25 mi radius      0.5 mi radius      1 mi radius

#### Housing

Total Housing Units (2018)	3,115		8,721		37,084	
Total Housing Units (2010)	1,063		6,026		30,933	
Historical Annual Growth (2010-2018)	2,053	24.1%	2,694	5.6%	6,151	2.5%
Housing Units Occupied (2018)	3,021	97.0%	8,454	96.9%	35,747	96.4%
Housing Units Owner-Occupied	278	9.2%	702	8.3%	4,850	13.6%
Housing Units Renter-Occupied	2,744	90.8%	7,752	91.7%	30,897	86.4%
Housing Units Vacant (2018)	94	3.1%	266	3.2%	1,336	3.7%

#### Household Size (2018)

Total Households	3,021		8,454		35,747	
1 Person Households	1,063	35.2%	2,869	33.9%	12,881	36.0%
2 Person Households	761	25.2%	2,196	26.0%	11,023	30.8%
3 Person Households	466	15.4%	1,334	15.8%	5,347	15.0%
4 Person Households	322	10.6%	967	11.4%	3,507	9.8%
5 Person Households	205	6.8%	565	6.7%	1,636	4.6%
6 Person Households	101	3.3%	264	3.1%	716	2.0%
7 or More Person Households	103	3.4%	260	3.1%	638	1.8%

#### Household Income Distribution (2018)

HH Income \$200,000 or More	409	13.5%	724	8.6%	3,785	10.6%
HH Income \$150,000 to \$199,999	282	9.3%	609	7.2%	2,751	7.7%
HH Income \$125,000 to \$149,999	208	6.9%	442	5.2%	2,264	6.3%
HH Income \$100,000 to \$124,999	268	8.9%	601	7.1%	3,231	9.0%
HH Income \$75,000 to \$99,999	324	10.7%	747	8.8%	4,067	11.4%
HH Income \$50,000 to \$74,999	529	17.5%	1,137	13.4%	5,296	14.8%
HH Income \$35,000 to \$49,999	222	7.3%	760	9.0%	3,572	10.0%
HH Income \$25,000 to \$34,999	258	8.6%	743	8.8%	2,798	7.8%
HH Income \$15,000 to \$24,999	217	7.2%	992	11.7%	2,850	8.0%
HH Income \$10,000 to \$14,999	109	3.6%	742	8.8%	1,886	5.3%
HH Income Under \$10,000	195	6.5%	957	11.3%	3,247	9.1%

#### Household Vehicles (2018)

Households 0 Vehicles Available	2,148	71.1%	6,135	72.6%	23,468	65.6%
Households 1 Vehicle Available	762	25.2%	2,004	23.7%	10,540	29.5%
Households 2 Vehicles Available	105	3.5%	281	3.3%	1,524	4.3%
Households 3 or More Vehicles Available	7	0.2%	35	0.4%	216	0.6%
Total Vehicles Available	995		2,688		14,283	
Average Vehicles per Household	0.3		0.3		0.4	
Owner-Occupied Household Vehicles	209	21.0%	592	22.0%	3,703	25.9%
Average Vehicles per Owner-Occupied Household	0.8		0.8		0.8	
Renter-Occupied Household Vehicles	786	79.0%	2,096	78.0%	10,580	74.1%
Average Vehicles per Renter-Occupied Household	0.3		0.3		0.3	

#### Travel Time (2015)

Worker Base Age 16 years or Over	3,590		10,973		44,625	
Travel to Work in 14 Minutes or Less	228	6.3%	751	6.8%	2,595	5.8%
Travel to Work in 15 to 29 Minutes	1,027	28.6%	2,749	25.1%	9,528	21.4%
Travel to Work in 30 to 59 Minutes	1,669	46.5%	5,345	48.7%	24,691	55.3%
Travel to Work in 60 Minutes or More	558	15.5%	1,615	14.7%	6,566	14.7%
Work at Home	134	3.7%	289	2.6%	1,167	2.6%
Average Minutes Travel to Work	32.7		34.1		35.4	

This report was produced using data from private and government sources deemed to be reliable. The information herein is provided without representation or warranty.

# COMPLETE PROFILE

2000-2010 Census, 2018 Estimates with 2023 Projections

Calculated using Weighted Block Centroid from Block Groups



Metro Commercial & Business Brokers, Inc.

Lat/Lon: 40.7518/-73.9385

RFULL9

## 41-04 27th St

### Long Island City, NY 11101

#### Transportation To Work (2015)

	0.25 mi radius		0.5 mi radius		1 mi radius	
Worker Base Age 16 years or Over	3,590		10,973		44,625	
Drive to Work Alone	492	13.7%	1,940	17.7%	7,114	15.9%
Drive to Work in Carpool	109	3.0%	363	3.3%	1,352	3.0%
Travel to Work by Public Transportation	2,569	71.6%	7,410	67.5%	31,063	69.6%
Drive to Work on Motorcycle	6	0.2%	40	0.4%	73	0.2%
Bicycle to Work	68	1.9%	131	1.2%	511	1.1%
Walk to Work	208	5.8%	756	6.9%	3,121	7.0%
Other Means	4	0.1%	44	0.4%	224	0.5%
Work at Home	134	3.7%	289	2.6%	1,167	2.6%

#### Daytime Demographics (2018)

	0.25 mi radius		0.5 mi radius		1 mi radius	
Total Businesses	536		1,524		4,952	
Total Employees	5,045		16,392		63,783	
Company Headquarter Businesses	3	0.6%	14	0.9%	39	0.8%
Company Headquarter Employees	81	1.6%	529	3.2%	2,676	4.2%
Employee Population per Business	9.4 to 1		10.8 to 1		12.9 to 1	
Residential Population per Business	14.4 to 1		14.2 to 1		17.0 to 1	
Adj. Daytime Demographics Age 16 Years or Over	6,803		22,886		87,540	

#### Labor Force

	0.25 mi radius		0.5 mi radius		1 mi radius	
Labor Population Age 16 Years or Over (2018)	6,444		17,640		70,450	
Labor Force Total Males (2018)	3,153	48.9%	8,220	46.6%	33,586	47.7%
Male Civilian Employed	2,441	77.4%	5,622	68.4%	24,174	72.0%
Male Civilian Unemployed	93	2.9%	367	4.5%	1,161	3.5%
Males in Armed Forces	-	-	-	-	-	-
Males Not in Labor Force	619	19.6%	2,232	27.2%	8,251	24.6%
Labor Force Total Females (2018)	3,292	51.1%	9,419	53.4%	36,864	52.3%
Female Civilian Employed	2,245	68.2%	5,525	58.6%	22,518	61.1%
Female Civilian Unemployed	58	1.8%	326	3.5%	1,134	3.1%
Females in Armed Forces	-	-	-	-	-	-
Females Not in Labor Force	988	30.0%	3,569	37.9%	13,211	35.8%
Unemployment Rate		2.3%		3.9%		3.3%
Labor Force Growth (2010-2018)	1,063	29.3%	374	3.5%	2,114	4.7%
Male Labor Force Growth (2010-2018)	538	28.3%	189	3.5%	1,036	4.5%
Female Labor Force Growth (2010-2018)	525	30.5%	185	3.5%	1,079	5.0%

#### Occupation (2015)

	0.25 mi radius		0.5 mi radius		1 mi radius	
Occupation Population Age 16 Years or Over	3,623		10,772		44,578	
Occupation Total Males	1,903	52.5%	5,432	50.4%	23,139	51.9%
Occupation Total Females	1,720	47.5%	5,340	49.6%	21,440	48.1%
Management, Business, Financial Operations	643	17.7%	1,786	16.6%	8,494	19.1%
Professional, Related	921	25.4%	2,589	24.0%	12,702	28.5%
Service	703	19.4%	2,293	21.3%	8,730	19.6%
Sales, Office	870	24.0%	2,704	25.1%	9,143	20.5%
Farming, Fishing, Forestry	1	-	5	-	12	-
Construction, Extraction, Maintenance	131	3.6%	416	3.9%	2,224	5.0%
Production, Transport, Material Moving	354	9.8%	979	9.1%	3,273	7.3%
White Collar Workers	2,434	67.2%	7,079	65.7%	30,339	68.1%
Blue Collar Workers	1,190	32.8%	3,692	34.3%	14,239	31.9%

This report was produced using data from private and government sources deemed to be reliable. The information herein is provided without representation or warranty.

# COMPLETE PROFILE

2000-2010 Census, 2018 Estimates with 2023 Projections

Calculated using Weighted Block Centroid from Block Groups



Metro Commercial & Business Brokers, Inc.

Lat/Lon: 40.7518/-73.9385

RFULL9

41-04 27th St Long Island City, NY 11101	0.25 mi radius		0.5 mi radius		1 mi radius	
<b>Units In Structure (2015)</b>						
Total Units	808		5,076		28,056	
1 Detached Unit	149	18.4%	494	9.7%	1,862	6.6%
1 Attached Unit	105	13.0%	370	7.3%	1,365	4.9%
2 Units	358	44.4%	1,554	30.6%	5,657	20.2%
3 to 4 Units	285	35.3%	1,061	20.9%	3,790	13.5%
5 to 9 Units	173	21.4%	621	12.2%	2,540	9.1%
10 to 19 Units	126	15.7%	403	7.9%	1,622	5.8%
20 to 49 Units	340	42.0%	1,363	26.8%	4,830	17.2%
50 or More Units	688	85.2%	2,296	45.2%	12,294	43.8%
Mobile Home or Trailer	4	0.4%	10	0.2%	42	0.1%
Other Structure	1	0.1%	3	-	8	-
<b>Homes Built By Year (2015)</b>						
Homes Built 2014 or later	24	3.0%	218	4.3%	461	1.6%
Homes Built 2010 to 2013	341	42.2%	1,147	22.6%	2,101	7.5%
Homes Built 2000 to 2009	407	50.4%	604	11.9%	2,885	10.3%
Homes Built 1990 to 1999	58	7.2%	171	3.4%	1,008	3.6%
Homes Built 1980 to 1989	28	3.4%	157	3.1%	1,154	4.1%
Homes Built 1970 to 1979	63	7.8%	198	3.9%	2,748	9.8%
Homes Built 1960 to 1969	127	15.7%	554	10.9%	2,783	9.9%
Homes Built 1950 to 1959	169	20.9%	559	11.0%	4,164	14.8%
Homes Built 1940 to 1949	161	19.9%	1,427	28.1%	4,785	17.1%
Homes Built Before 1939	889	110.0	3,153	62.1%	11,967	42.7%
Median Age of Homes	55.9 yrs		62.0 yrs		58.7 yrs	
<b>Home Values (2015)</b>						
Owner Specified Housing Units	155		598		4,403	
Home Values \$1,000,000 or More	10	6.4%	73	12.3%	617	14.0%
Home Values \$750,000 to \$999,999	22	14.4%	135	22.7%	792	18.0%
Home Values \$500,000 to \$749,999	74	47.6%	226	37.7%	1,326	30.1%
Home Values \$400,000 to \$499,999	34	21.8%	86	14.3%	568	12.9%
Home Values \$300,000 to \$399,999	16	10.4%	58	9.7%	526	12.0%
Home Values \$250,000 to \$299,999	12	8.0%	27	4.6%	264	6.0%
Home Values \$200,000 to \$249,999	6	3.9%	23	3.8%	255	5.8%
Home Values \$175,000 to \$199,999	2	1.0%	6	1.0%	58	1.3%
Home Values \$150,000 to \$174,999	3	1.7%	8	1.4%	92	2.1%
Home Values \$125,000 to \$149,999	1	0.7%	4	0.6%	33	0.7%
Home Values \$100,000 to \$124,999	1	0.8%	6	0.9%	40	0.9%
Home Values \$90,000 to \$99,999	1	0.6%	1	0.2%	5	0.1%
Home Values \$80,000 to \$89,999	-	-	6	1.0%	10	0.2%
Home Values \$70,000 to \$79,999	-	-	1	0.1%	7	0.2%
Home Values \$60,000 to \$69,999	-	-	-	-	4	0.1%
Home Values \$50,000 to \$59,999	1	0.6%	1	0.2%	14	0.3%
Home Values \$35,000 to \$49,999	-	0.3%	5	0.8%	20	0.5%
Home Values \$25,000 to \$34,999	-	0.1%	2	0.3%	11	0.2%
Home Values \$10,000 to \$24,999	-	-	1	0.2%	27	0.6%
Home Values Under \$10,000	1	0.5%	2	0.3%	27	0.6%
Owner-Occupied Median Home Value	\$547,593		\$621,078		\$589,428	
Renter-Occupied Median Rent	\$1,316		\$1,367		\$1,417	

This report was produced using data from private and government sources deemed to be reliable. The information herein is provided without representation or warranty.

# COMPLETE PROFILE

2000-2010 Census, 2018 Estimates with 2023 Projections

Calculated using Weighted Block Centroid from Block Groups



Metro Commercial & Business Brokers, Inc.

Lat/Lon: 40.7518/-73.9385

RFULL9

## 41-04 27th St

## Long Island City, NY 11101

0.25 mi radius

0.5 mi radius

1 mi radius

### Total Annual Consumer Expenditure (2018)

Total Household Expenditure	\$155 M	\$403 M	\$2.23 B
Total Non-Retail Expenditure	\$82.2 M	\$214 M	\$1.18 B
Total Retail Expenditure	\$72.3 M	\$190 M	\$1.05 B
Apparel	\$5.54 M	\$14.4 M	\$79.5 M
Contributions	\$7.40 M	\$18.2 M	\$105 M
Education	\$6.69 M	\$16.8 M	\$94.7 M
Entertainment	\$8.70 M	\$22.4 M	\$125 M
Food and Beverages	\$22.3 M	\$59.1 M	\$323 M
Furnishings and Equipment	\$5.43 M	\$13.8 M	\$78.3 M
Gifts	\$4.17 M	\$10.5 M	\$59.6 M
Health Care	\$11.9 M	\$32.0 M	\$174 M
Household Operations	\$4.70 M	\$11.8 M	\$66.8 M
Miscellaneous Expenses	\$2.26 M	\$5.97 M	\$32.8 M
Personal Care	\$2.01 M	\$5.28 M	\$29.1 M
Personal Insurance	\$1.23 M	\$3.09 M	\$17.5 M
Reading	\$348 K	\$903 K	\$5.04 M
Shelter	\$32.1 M	\$84.0 M	\$463 M
Tobacco	\$848 K	\$2.40 M	\$12.5 M
Transportation	\$27.6 M	\$72.2 M	\$401 M
Utilities	\$11.3 M	\$30.4 M	\$164 M

### Monthly Household Consumer Expenditure (2018)

Total Household Expenditure	\$4,262	\$3,974	\$5,199
Total Non-Retail Expenditure	\$2,267 53.2%	\$2,106 53.0%	\$2,757 53.0%
Total Retail Expenditures	\$1,995 46.8%	\$1,869 47.0%	\$2,442 47.0%
Apparel	\$153 3.6%	\$142 3.6%	\$185 3.6%
Contributions	\$204 4.8%	\$179 4.5%	\$244 4.7%
Education	\$185 4.3%	\$166 4.2%	\$221 4.2%
Entertainment	\$240 5.6%	\$221 5.6%	\$292 5.6%
Food and Beverages	\$615 14.4%	\$583 14.7%	\$752 14.5%
Furnishings and Equipment	\$150 3.5%	\$136 3.4%	\$183 3.5%
Gifts	\$115 2.7%	\$103 2.6%	\$139 2.7%
Health Care	\$328 7.7%	\$315 7.9%	\$405 7.8%
Household Operations	\$130 3.0%	\$116 2.9%	\$156 3.0%
Miscellaneous Expenses	\$62 1.5%	\$59 1.5%	\$77 1.5%
Personal Care	\$56 1.3%	\$52 1.3%	\$68 1.3%
Personal Insurance	\$34 0.8%	\$30 0.8%	\$41 0.8%
Reading	\$10 0.2%	\$9 0.2%	\$12 0.2%
Shelter	\$886 20.8%	\$828 20.8%	\$1,080 20.8%
Tobacco	\$23 0.5%	\$24 0.6%	\$29 0.6%
Transportation	\$761 17.9%	\$711 17.9%	\$934 18.0%
Utilities	\$312 7.3%	\$300 7.5%	\$383 7.4%

This report was produced using data from private and government sources deemed to be reliable. The information herein is provided without representation or warranty.