

ELMHURST QUEENS BOULEVARD

LOCATION:

89-23 Queens Boulevard
Elmhurst, Queens, NY 11373

SIZE: GLA 4,477 Rentable square feet

89-23 Queens Blvd: Available 2,340 SF

89-25A Queens Blvd: Tea Do 972 SF

89-25B Queens Blvd: BoostMobile 1,165 SF

No Basement or Sprinkler System.

CALL FOR AVAILABILITIES

ZONING: C1-2 Overlay in R6.

PARKING: Metered Street Parking and
Garages near by.

OTHER PROJECT TENANTS: Chase
Bank

NEARBY TENANTS: On same block with White Castle and Bank of America. Between Queens Center Mall featuring JC Penny's, Macy's and many others and Queens Place featuring Target, Best Buy, DSW and others.

NEIGHBORHOOD: Densely populated middle income neighborhood, near Subway  lines and numerous bus Lines. Tremendous Pedestrian and Vehicular Traffic.

PRICE: TBD **RE Tax - \$26/sq ft, CAM & Insurance - \$5/sq ft.**

NOTE: Excellent Queens Blvd location between two major Malls. Heavy Pedestrian Traffic!



2017	1/2 Mile	1 Mile	3 Mile
Estimated Population	42,975	188,595	911,383
Estimated Average HH Income	\$72,103	\$67,785	\$75,238



This property is offered subject to availability, errors, omissions, or changes in price or terms without notice. ID #2465

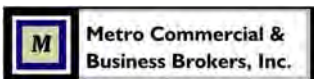

For more information and inspection, contact
Metro Commercial & Business Brokers, Inc.
425 Linda Drive, East Meadow, NY 11554
www.metrocbb.com



John R. Wilmarth
(516) 640-5440 john@metrocb.com

Gerry Dantone
(631) 623-6914 metrocb@aol.com

89-23 Queens Blvd, Elmhurst, Queens, NY 11373



M Metro Commercial & Business Brokers, Inc.

For more information and inspection, contact
Metro Commercial & Business Brokers, Inc.
 425 Linda Drive, East Meadow, NY 11554

Member of
 International Council
 of Shopping Centers

www.metrocbb.com

John R. Wilmarth
 (516) 640-5440 john@metrocb.com

Gerry Dantone
 (631) 623-6914 metrocb@aol.com

89-23 25 Queens Blvd, Elmhurst, Queens, NY 11373

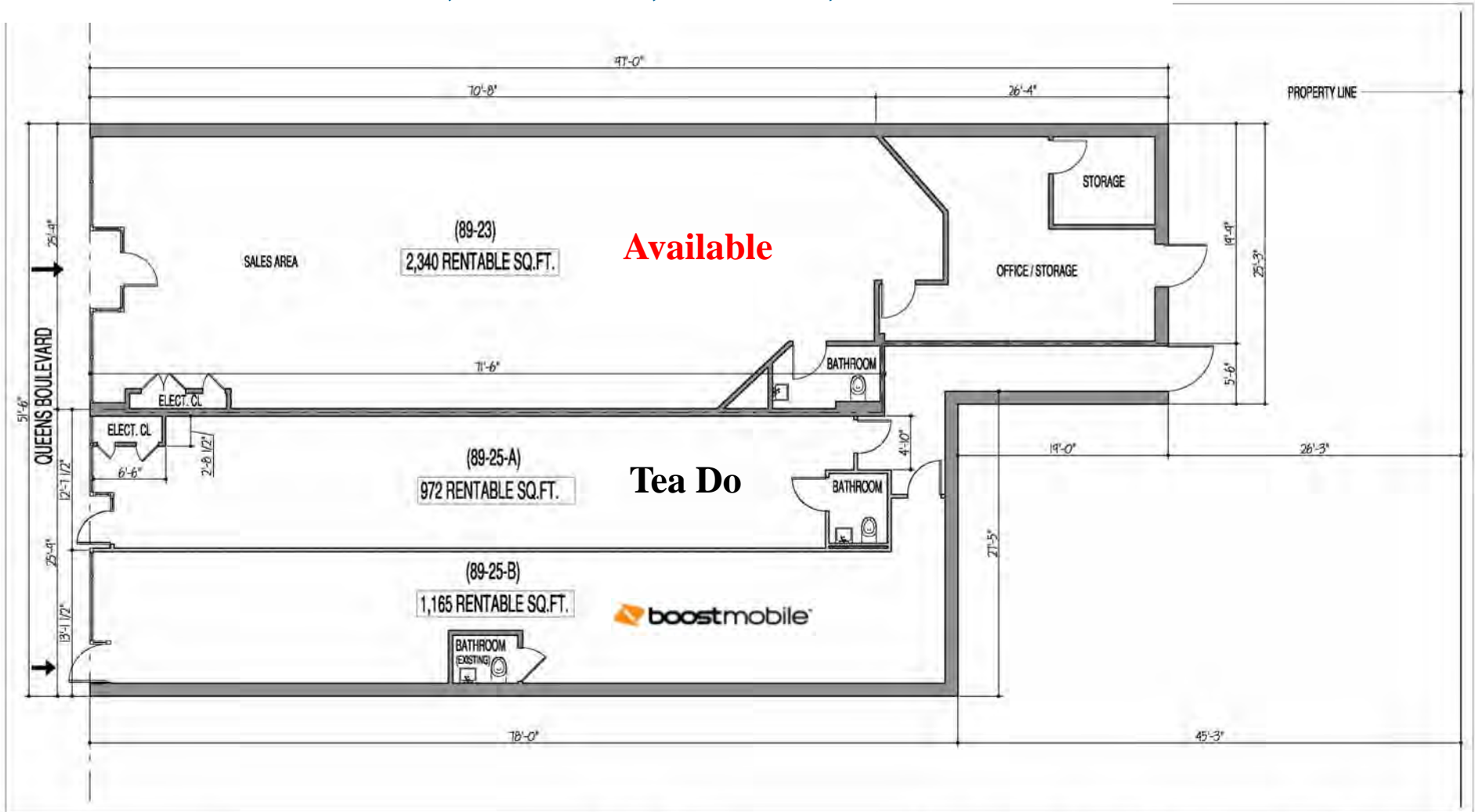

8923 & 8925 Queens Blvd.
Elmhurst, NY

DRAWING TITLE
AS-BUILT PLANS
'QUEENS BOULEVARD'

JOB NUMBER 33069.00 DRAWING NO.
DRAWN BY CL **A.1**
SCALE 1/8"=1'-0"

**TULLER
McNEALUS
FELD**
ARCHITECTURE
INTERIOR DESIGN
54 West 38th Street
New York, NY 10018
TEL: (212) 768-7788
FAX: (212) 768-8171



For more information and inspection, contact
Metro Commercial & Business Brokers, Inc.
425 Linda Drive, East Meadow, NY 11554
www.metrocbb.com



John R. Wilmarth
(516) 640-5440 john@metrocb.com

Gerry Dantone
(631) 623-6914 metrocb@aol.com

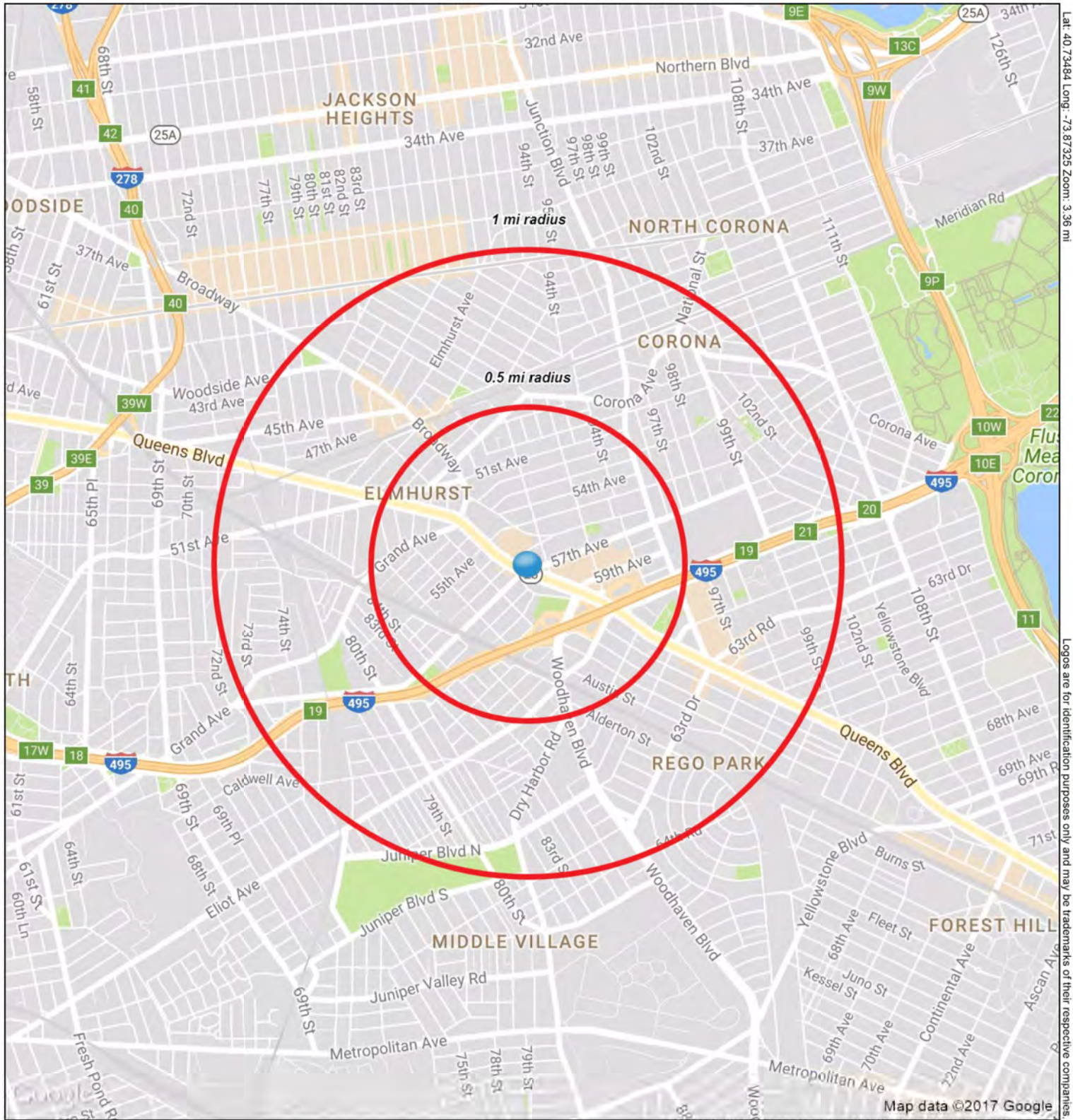

Lat: 40.73484 Long: -73.87325 Zoom: 3.36 mi

Logos are for identification purposes only and may be trademarks of their respective companies.

89-25 Queens Blvd

Elmhurst, NY 11373



**Metro Commercial &
Business Brokers, Inc.**

October 2017

Metro Commercial & Business Brokers, Inc.

This map was produced using data from private and government sources deemed to be reliable. The information herein is provided without representation or warranty.

COMPLETE PROFILE

2000-2010 Census, 2017 Estimates with 2022 Projections

Calculated using Weighted Block Centroid from Block Groups



Metro Commercial & Business Brokers, Inc.

Lat/Lon: 40.7347/-73.8735

RFULL9

89-25 Queens Blvd Elmhurst, NY 11373	0.5 mi radius	1 mi radius	3 mi radius
Population			
Estimated Population (2017)	42,975	188,595	911,383
Projected Population (2022)	45,011	197,471	957,863
Census Population (2010)	41,095	180,740	870,458
Census Population (2000)	38,958	178,096	866,544
Projected Annual Growth (2017-2022)	2,036 0.9%	8,876 0.9%	46,480 1.0%
Historical Annual Growth (2010-2017)	1,880 0.7%	7,855 0.6%	40,925 0.7%
Historical Annual Growth (2000-2010)	2,137 0.5%	2,644 0.1%	3,914 -
Estimated Population Density (2017)	54,813 <i>psm</i>	60,056 <i>psm</i>	32,246 <i>psm</i>
Trade Area Size	0.8 <i>sq mi</i>	3.1 <i>sq mi</i>	28.3 <i>sq mi</i>
Households			
Estimated Households (2017)	14,577	63,480	322,398
Projected Households (2022)	15,185	66,010	336,708
Census Households (2010)	14,054	61,241	310,348
Census Households (2000)	13,553	60,651	312,889
Projected Annual Growth (2017-2022)	608 0.8%	2,530 0.8%	14,310 0.9%
Historical Annual Change (2000-2017)	1,024 0.4%	2,829 0.3%	9,508 0.2%
Average Household Income			
Estimated Average Household Income (2017)	\$72,103	\$67,785	\$75,238
Projected Average Household Income (2022)	\$88,925	\$83,346	\$92,427
Census Average Household Income (2010)	\$65,951	\$59,591	\$64,424
Census Average Household Income (2000)	\$50,432	\$48,427	\$51,087
Projected Annual Change (2017-2022)	\$16,822 4.7%	\$15,561 4.6%	\$17,189 4.6%
Historical Annual Change (2000-2017)	\$21,671 2.5%	\$19,358 2.4%	\$24,151 2.8%
Median Household Income			
Estimated Median Household Income (2017)	\$59,187	\$56,238	\$61,711
Projected Median Household Income (2022)	\$69,268	\$65,928	\$72,590
Census Median Household Income (2010)	\$52,680	\$48,365	\$52,862
Census Median Household Income (2000)	\$40,239	\$38,767	\$41,521
Projected Annual Change (2017-2022)	\$10,082 3.4%	\$9,690 3.4%	\$10,879 3.5%
Historical Annual Change (2000-2017)	\$18,947 2.8%	\$17,471 2.7%	\$20,190 2.9%
Per Capita Income			
Estimated Per Capita Income (2017)	\$24,469	\$22,830	\$26,651
Projected Per Capita Income (2022)	\$30,011	\$27,874	\$32,524
Census Per Capita Income (2010)	\$22,555	\$20,192	\$22,969
Census Per Capita Income (2000)	\$17,240	\$16,382	\$18,353
Projected Annual Change (2017-2022)	\$5,542 4.5%	\$5,044 4.4%	\$5,873 4.4%
Historical Annual Change (2000-2017)	\$7,228 2.5%	\$6,448 2.3%	\$8,297 2.7%
Estimated Average Household Net Worth (2017)	\$683,755	\$631,635	\$720,205

This report was produced using data from private and government sources deemed to be reliable. The information herein is provided without representation or warranty.

COMPLETE PROFILE

2000-2010 Census, 2017 Estimates with 2022 Projections

Calculated using Weighted Block Centroid from Block Groups



Metro Commercial & Business Brokers, Inc.

Lat/Lon: 40.7347/-73.8735

RFULL9

89-25 Queens Blvd Elmhurst, NY 11373	0.5 mi radius		1 mi radius		3 mi radius	
Race and Ethnicity						
Total Population (2017)	42,975		188,595		911,383	
White (2017)	11,240	26.2%	65,940	35.0%	405,648	44.5%
Black or African American (2017)	2,279	5.3%	14,343	7.6%	62,597	6.9%
American Indian or Alaska Native (2017)	216	0.5%	1,093	0.6%	5,550	0.6%
Asian (2017)	23,822	55.4%	72,004	38.2%	258,318	28.3%
Hawaiian or Pacific Islander (2017)	20	-	80	-	372	-
Other Race (2017)	4,111	9.6%	28,058	14.9%	143,954	15.8%
Two or More Races (2017)	1,287	3.0%	7,076	3.8%	34,944	3.8%
Population < 18 (2017)	7,777	18.1%	37,262	19.8%	181,575	19.9%
White Not Hispanic	784	10.1%	5,818	15.6%	41,740	23.0%
Black or African American	418	5.4%	2,558	6.9%	10,940	6.0%
Asian	4,040	51.9%	12,747	34.2%	46,046	25.4%
Other Race Not Hispanic	160	2.1%	733	2.0%	3,862	2.1%
Hispanic	2,376	30.6%	15,407	41.3%	78,987	43.5%
Not Hispanic or Latino Population (2017)	31,844	74.1%	120,828	64.1%	569,630	62.5%
Not Hispanic White	5,671	17.8%	34,702	28.7%	251,360	44.1%
Not Hispanic Black or African American	1,899	6.0%	11,382	9.4%	46,108	8.1%
Not Hispanic American Indian or Alaska Native	69	0.2%	265	0.2%	1,142	0.2%
Not Hispanic Asian	23,264	73.1%	70,598	58.4%	252,849	44.4%
Not Hispanic Hawaiian or Pacific Islander	15	-	48	-	186	-
Not Hispanic Other Race	252	0.8%	1,087	0.9%	5,196	0.9%
Not Hispanic Two or More Races	674	2.1%	2,746	2.3%	12,789	2.2%
Hispanic or Latino Population (2017)	11,131	25.9%	67,767	35.9%	341,753	37.5%
Hispanic White	5,570	50.0%	31,238	46.1%	154,288	45.1%
Hispanic Black or African American	379	3.4%	2,961	4.4%	16,489	4.8%
Hispanic American Indian or Alaska Native	147	1.3%	829	1.2%	4,408	1.3%
Hispanic Asian	558	5.0%	1,406	2.1%	5,469	1.6%
Hispanic Hawaiian or Pacific Islander	5	-	33	-	186	0.1%
Hispanic Other Race	3,859	34.7%	26,970	39.8%	138,759	40.6%
Hispanic Two or More Races	613	5.5%	4,330	6.4%	22,154	6.5%
Not Hispanic or Latino Population (2010)	29,461	71.7%	111,368	61.6%	530,068	60.9%
Hispanic or Latino Population (2010)	11,634	28.3%	69,372	38.4%	340,390	39.1%
Not Hispanic or Latino Population (2000)	27,646	71.0%	113,164	63.5%	559,540	64.6%
Hispanic or Latino Population (2000)	11,312	29.0%	64,933	36.5%	307,004	35.4%
Not Hispanic or Latino Population (2022)	33,318	74.0%	126,142	63.9%	592,727	61.9%
Hispanic or Latino Population (2022)	11,692	26.0%	71,329	36.1%	365,135	38.1%
Projected Annual Growth (2017-2022)	561	1.0%	3,562	1.1%	23,383	1.4%
Historical Annual Growth (2000-2010)	322	0.3%	4,439	0.7%	33,386	1.1%

This report was produced using data from private and government sources deemed to be reliable. The information herein is provided without representation or warranty.

COMPLETE PROFILE

2000-2010 Census, 2017 Estimates with 2022 Projections

Calculated using Weighted Block Centroid from Block Groups



Metro Commercial & Business Brokers, Inc.

Lat/Lon: 40.7347/-73.8735

RFULL9

89-25 Queens Blvd

Elmhurst, NY 11373

0.5 mi radius

1 mi radius

3 mi radius

Total Age Distribution (2017)

	0.5 mi radius	1 mi radius	3 mi radius
Total Population	42,975	188,595	911,383
Age Under 5 Years	2,478 5.8%	12,154 6.4%	59,787 6.6%
Age 5 to 9 Years	2,157 5.0%	10,525 5.6%	51,079 5.6%
Age 10 to 14 Years	1,988 4.6%	9,277 4.9%	45,270 5.0%
Age 15 to 19 Years	1,977 4.6%	9,179 4.9%	44,299 4.9%
Age 20 to 24 Years	2,736 6.4%	11,993 6.4%	56,921 6.2%
Age 25 to 29 Years	3,802 8.8%	15,809 8.4%	76,462 8.4%
Age 30 to 34 Years	3,610 8.4%	15,630 8.3%	79,836 8.8%
Age 35 to 39 Years	3,225 7.5%	14,572 7.7%	73,623 8.1%
Age 40 to 44 Years	2,982 6.9%	13,179 7.0%	65,781 7.2%
Age 45 to 49 Years	3,033 7.1%	12,820 6.8%	61,734 6.8%
Age 50 to 54 Years	2,991 7.0%	12,748 6.8%	60,525 6.6%
Age 55 to 59 Years	3,094 7.2%	12,698 6.7%	58,652 6.4%
Age 60 to 64 Years	2,661 6.2%	11,245 6.0%	51,343 5.6%
Age 65 to 69 Years	2,031 4.7%	8,684 4.6%	41,097 4.5%
Age 70 to 74 Years	1,539 3.6%	6,645 3.5%	30,095 3.3%
Age 75 to 79 Years	1,085 2.5%	4,644 2.5%	21,703 2.4%
Age 80 to 84 Years	819 1.9%	3,260 1.7%	15,181 1.7%
Age 85 Years or Over	767 1.8%	3,532 1.9%	17,996 2.0%
Median Age	38.4	37.7	37.2
Age 19 Years or Less	8,601 20.0%	41,135 21.8%	200,435 22.0%
Age 20 to 64 Years	28,134 65.5%	120,695 64.0%	584,877 64.2%
Age 65 Years or Over	6,240 14.5%	26,765 14.2%	126,071 13.8%

Female Age Distribution (2017)

	0.5 mi radius	1 mi radius	3 mi radius
Female Population	22,158 51.6%	95,128 50.4%	458,471 50.3%
Age Under 5 Years	1,188 5.4%	5,793 6.1%	28,785 6.3%
Age 5 to 9 Years	1,043 4.7%	5,001 5.3%	24,472 5.3%
Age 10 to 14 Years	974 4.4%	4,500 4.7%	21,810 4.8%
Age 15 to 19 Years	983 4.4%	4,344 4.6%	20,868 4.6%
Age 20 to 24 Years	1,344 6.1%	5,537 5.8%	26,884 5.9%
Age 25 to 29 Years	1,925 8.7%	7,744 8.1%	37,601 8.2%
Age 30 to 34 Years	1,855 8.4%	7,612 8.0%	38,603 8.4%
Age 35 to 39 Years	1,548 7.0%	6,962 7.3%	34,926 7.6%
Age 40 to 44 Years	1,508 6.8%	6,350 6.7%	31,375 6.8%
Age 45 to 49 Years	1,539 6.9%	6,283 6.6%	30,199 6.6%
Age 50 to 54 Years	1,590 7.2%	6,581 6.9%	30,822 6.7%
Age 55 to 59 Years	1,643 7.4%	6,790 7.1%	30,685 6.7%
Age 60 to 64 Years	1,423 6.4%	6,049 6.4%	27,705 6.0%
Age 65 to 69 Years	1,118 5.0%	4,792 5.0%	22,563 4.9%
Age 70 to 74 Years	867 3.9%	3,695 3.9%	16,880 3.7%
Age 75 to 79 Years	621 2.8%	2,713 2.9%	12,604 2.7%
Age 80 to 84 Years	490 2.2%	1,987 2.1%	9,493 2.1%
Age 85 Years or Over	498 2.2%	2,394 2.5%	12,196 2.7%
Female Median Age	39.9	39.5	38.7
Age 19 Years or Less	4,188 18.9%	19,638 20.6%	95,936 20.9%
Age 20 to 64 Years	14,375 64.9%	59,909 63.0%	288,801 63.0%
Age 65 Years or Over	3,595 16.2%	15,582 16.4%	73,734 16.1%

This report was produced using data from private and government sources deemed to be reliable. The information herein is provided without representation or warranty.

COMPLETE PROFILE

2000-2010 Census, 2017 Estimates with 2022 Projections

Calculated using Weighted Block Centroid from Block Groups



Metro Commercial & Business Brokers, Inc.

Lat/Lon: 40.7347/-73.8735

RFULL9

89-25 Queens Blvd

Elmhurst, NY 11373

0.5 mi radius 1 mi radius 3 mi radius

Male Age Distribution (2017)

	0.5 mi radius	1 mi radius	3 mi radius
Male Population	20,817 48.4%	93,467 49.6%	452,912 49.7%
Age Under 5 Years	1,290 6.2%	6,362 6.8%	31,001 6.8%
Age 5 to 9 Years	1,115 5.4%	5,525 5.9%	26,607 5.9%
Age 10 to 14 Years	1,014 4.9%	4,776 5.1%	23,459 5.2%
Age 15 to 19 Years	994 4.8%	4,835 5.2%	23,430 5.2%
Age 20 to 24 Years	1,392 6.7%	6,457 6.9%	30,038 6.6%
Age 25 to 29 Years	1,876 9.0%	8,065 8.6%	38,861 8.6%
Age 30 to 34 Years	1,755 8.4%	8,019 8.6%	41,233 9.1%
Age 35 to 39 Years	1,678 8.1%	7,610 8.1%	38,697 8.5%
Age 40 to 44 Years	1,474 7.1%	6,829 7.3%	34,406 7.6%
Age 45 to 49 Years	1,494 7.2%	6,536 7.0%	31,534 7.0%
Age 50 to 54 Years	1,401 6.7%	6,166 6.6%	29,703 6.6%
Age 55 to 59 Years	1,451 7.0%	5,908 6.3%	27,967 6.2%
Age 60 to 64 Years	1,238 5.9%	5,196 5.6%	23,637 5.2%
Age 65 to 69 Years	912 4.4%	3,892 4.2%	18,534 4.1%
Age 70 to 74 Years	671 3.2%	2,949 3.2%	13,216 2.9%
Age 75 to 79 Years	464 2.2%	1,931 2.1%	9,100 2.0%
Age 80 to 84 Years	329 1.6%	1,273 1.4%	5,688 1.3%
Age 85 Years or Over	269 1.3%	1,139 1.2%	5,800 1.3%
Male Median Age	37.1	36.1	35.8
Age 19 Years or Less	4,412 21.2%	21,497 23.0%	104,498 23.1%
Age 20 to 64 Years	13,759 66.1%	60,786 65.0%	296,076 65.4%
Age 65 Years or Over	2,645 12.7%	11,184 12.0%	52,337 11.6%

Males per 100 Females (2017)

	0.5 mi radius	1 mi radius	3 mi radius
Overall Comparison	94	98	99
Age Under 5 Years	109 52.1%	110 52.3%	108 51.9%
Age 5 to 9 Years	107 51.7%	110 52.5%	109 52.1%
Age 10 to 14 Years	104 51.0%	106 51.5%	108 51.8%
Age 15 to 19 Years	101 50.3%	111 52.7%	112 52.9%
Age 20 to 24 Years	104 50.9%	117 53.8%	112 52.8%
Age 25 to 29 Years	97 49.4%	104 51.0%	103 50.8%
Age 30 to 34 Years	95 48.6%	105 51.3%	107 51.6%
Age 35 to 39 Years	108 52.0%	109 52.2%	111 52.6%
Age 40 to 44 Years	98 49.4%	108 51.8%	110 52.3%
Age 45 to 49 Years	97 49.3%	104 51.0%	104 51.1%
Age 50 to 54 Years	88 46.8%	94 48.4%	96 49.1%
Age 55 to 59 Years	88 46.9%	87 46.5%	91 47.7%
Age 60 to 64 Years	87 46.5%	86 46.2%	85 46.0%
Age 65 to 69 Years	82 44.9%	81 44.8%	82 45.1%
Age 70 to 74 Years	77 43.6%	80 44.4%	78 43.9%
Age 75 to 79 Years	75 42.8%	71 41.6%	72 41.9%
Age 80 to 84 Years	67 40.1%	64 39.0%	60 37.5%
Age 85 Years or Over	54 35.0%	48 32.2%	48 32.2%
Age 19 Years or Less	105 51.3%	109 52.3%	109 52.1%
Age 20 to 39 Years	100 50.1%	108 52.0%	108 51.9%
Age 40 to 64 Years	92 47.8%	96 48.9%	98 49.4%
Age 65 Years or Over	74 42.4%	72 41.8%	71 41.5%

This report was produced using data from private and government sources deemed to be reliable. The information herein is provided without representation or warranty.

COMPLETE PROFILE

2000-2010 Census, 2017 Estimates with 2022 Projections

Calculated using Weighted Block Centroid from Block Groups



Metro Commercial & Business Brokers, Inc.

Lat/Lon: 40.7347/-73.8735

RFULL9

89-25 Queens Blvd

Elmhurst, NY 11373

	0.5 mi radius	1 mi radius	3 mi radius
Household Type (2017)			
Total Households	14,577	63,480	322,398
Households with Children	4,542 31.2%	20,993 33.1%	100,943 31.3%
Average Household Size	2.9	3.0	2.8
Household Density per Square Mile	18,593	20,215	11,407
Population Family	36,763 85.5%	161,242 85.5%	756,722 83.0%
Population Non-Family	6,163 14.3%	26,837 14.2%	149,618 16.4%
Population Group Quarters	49 0.1%	516 0.3%	5,042 0.6%
Family Households	10,273 70.5%	44,125 69.5%	212,766 66.0%
Married Couple Households	7,134 69.4%	29,596 67.1%	144,767 68.0%
Other Family Households	3,139 30.6%	14,529 32.9%	67,999 32.0%
Family Households with Children	4,504 43.8%	20,785 47.1%	100,064 47.0%
Married Couple with Children	3,230 71.7%	14,286 68.7%	68,864 68.8%
Other Family Households with Children	1,274 28.3%	6,499 31.3%	31,200 31.2%
Family Households No Children	5,769 56.2%	23,340 52.9%	112,702 53.0%
Married Couple No Children	3,904 67.7%	15,310 65.6%	75,903 67.3%
Other Family Households No Children	1,865 32.3%	8,030 34.4%	36,799 32.7%
Non-Family Households	4,304 29.5%	19,355 30.5%	109,631 34.0%
Non-Family Households with Children	37 0.9%	209 1.1%	879 0.8%
Non-Family Households No Children	4,266 99.1%	19,147 98.9%	108,752 99.2%
Average Family Household Size	3.6	3.7	3.6
Average Family Income	\$81,187	\$76,836	\$84,456
Median Family Income	\$67,991	\$65,208	\$71,836
Average Non-Family Household Size	1.4	1.4	1.4
Marital Status (2017)			
Population Age 15 Years or Over	36,351	156,639	755,247
Never Married	13,047 35.9%	57,878 37.0%	292,311 38.7%
Currently Married	14,793 40.7%	60,533 38.6%	298,390 39.5%
Previously Married	8,512 23.4%	38,228 24.4%	164,546 21.8%
Separated	3,808 44.7%	16,205 42.4%	66,883 40.6%
Widowed	1,978 23.2%	9,636 25.2%	41,410 25.2%
Divorced	2,726 32.0%	12,387 32.4%	56,252 34.2%
Educational Attainment (2017)			
Adult Population Age 25 Years or Over	31,638	135,467	654,027
Elementary (Grade Level 0 to 8)	4,022 12.7%	19,517 14.4%	82,451 12.6%
Some High School (Grade Level 9 to 11)	2,403 7.6%	12,237 9.0%	56,173 8.6%
High School Graduate	7,143 22.6%	33,619 24.8%	177,327 27.1%
Some College	4,624 14.6%	18,628 13.8%	86,230 13.2%
Associate Degree Only	2,165 6.8%	9,474 7.0%	46,646 7.1%
Bachelor Degree Only	7,531 23.8%	28,008 20.7%	130,880 20.0%
Graduate Degree	3,749 11.9%	13,984 10.3%	74,320 11.4%
Any College (Some College or Higher)	18,070 57.1%	70,094 51.7%	338,076 51.7%
College Degree + (Bachelor Degree or Higher)	11,280 35.7%	41,992 31.0%	205,200 31.4%

This report was produced using data from private and government sources deemed to be reliable. The information herein is provided without representation or warranty.

COMPLETE PROFILE

2000-2010 Census, 2017 Estimates with 2022 Projections

Calculated using Weighted Block Centroid from Block Groups



Metro Commercial & Business Brokers, Inc.

Lat/Lon: 40.7347/-73.8735

RFULL9

89-25 Queens Blvd

Elmhurst, NY 11373

Housing

	0.5 mi radius		1 mi radius		3 mi radius	
Total Housing Units (2017)	15,042		65,498		335,646	
Total Housing Units (2010)	14,819		64,496		331,829	
Historical Annual Growth (2010-2017)	223	0.2%	1,001	0.2%	3,816	0.2%
Housing Units Occupied (2017)	14,577	96.9%	63,480	96.9%	322,398	96.1%
Housing Units Owner-Occupied	5,047	34.6%	20,109	31.7%	111,971	34.7%
Housing Units Renter-Occupied	9,530	65.4%	43,371	68.3%	210,426	65.3%
Housing Units Vacant (2017)	465	3.2%	2,017	3.2%	13,248	4.1%

Household Size (2017)

Total Households	14,577		63,480		322,398	
1 Person Households	3,140	21.5%	14,766	23.3%	83,170	25.8%
2 Person Households	3,790	26.0%	15,635	24.6%	85,342	26.5%
3 Person Households	2,779	19.1%	11,443	18.0%	56,147	17.4%
4 Person Households	2,398	16.5%	10,035	15.8%	46,814	14.5%
5 Person Households	1,279	8.8%	5,641	8.9%	25,024	7.8%
6 Person Households	587	4.0%	2,784	4.4%	12,307	3.8%
7 or More Person Households	603	4.1%	3,176	5.0%	13,595	4.2%

Household Income Distribution (2017)

HH Income \$200,000 or More	720	4.9%	2,741	4.3%	16,831	5.2%
HH Income \$150,000 to \$199,999	799	5.5%	3,198	5.0%	20,039	6.2%
HH Income \$125,000 to \$149,999	915	6.3%	3,200	5.0%	18,926	5.9%
HH Income \$100,000 to \$124,999	1,311	9.0%	5,538	8.7%	28,843	8.9%
HH Income \$75,000 to \$99,999	1,777	12.2%	7,588	12.0%	40,676	12.6%
HH Income \$50,000 to \$74,999	2,786	19.1%	11,273	17.8%	58,934	18.3%
HH Income \$35,000 to \$49,999	1,680	11.5%	8,577	13.5%	40,652	12.6%
HH Income \$25,000 to \$34,999	1,176	8.1%	6,180	9.7%	29,732	9.2%
HH Income \$15,000 to \$24,999	1,392	9.5%	6,829	10.8%	31,984	9.9%
HH Income \$10,000 to \$14,999	803	5.5%	3,045	4.8%	13,292	4.1%
HH Income Under \$10,000	1,219	8.4%	5,313	8.4%	22,489	7.0%

Household Vehicles (2017)

Households 0 Vehicles Available	6,865	47.1%	31,500	49.6%	148,131	45.9%
Households 1 Vehicle Available	5,768	39.6%	24,154	38.0%	128,667	39.9%
Households 2 Vehicles Available	1,554	10.7%	6,087	9.6%	36,147	11.2%
Households 3 or More Vehicles Available	391	2.7%	1,739	2.7%	9,453	2.9%
Total Vehicles Available	10,284		42,042		232,579	
Average Vehicles per Household	0.7		0.7		0.7	
Owner-Occupied Household Vehicles	5,301	51.5%	20,676	49.2%	121,911	52.4%
Average Vehicles per Owner-Occupied Household	1.1		1.0		1.1	
Renter-Occupied Household Vehicles	4,982	48.5%	21,366	50.8%	110,668	47.6%
Average Vehicles per Renter-Occupied Household	0.5		0.5		0.5	

Travel Time (2015)

Worker Base Age 16 years or Over	22,289		95,373		466,935	
Travel to Work in 14 Minutes or Less	1,352	6.1%	5,936	6.2%	31,154	6.7%
Travel to Work in 15 to 29 Minutes	3,390	15.2%	15,060	15.8%	74,881	16.0%
Travel to Work in 30 to 59 Minutes	11,106	49.8%	45,854	48.1%	232,633	49.8%
Travel to Work in 60 Minutes or More	6,017	27.0%	25,799	27.1%	117,044	25.1%
Work at Home	357	1.6%	1,572	1.6%	9,565	2.0%
Average Minutes Travel to Work	44.4		42.8		41.2	

This report was produced using data from private and government sources deemed to be reliable. The information herein is provided without representation or warranty.

COMPLETE PROFILE

2000-2010 Census, 2017 Estimates with 2022 Projections

Calculated using Weighted Block Centroid from Block Groups



Metro Commercial & Business Brokers, Inc.

Lat/Lon: 40.7347/-73.8735

RFULL9

89-25 Queens Blvd Elmhurst, NY 11373	0.5 mi radius		1 mi radius		3 mi radius	
Transportation To Work (2015)						
Worker Base Age 16 years or Over	22,289		95,373		466,935	
Drive to Work Alone	5,547	24.9%	25,194	26.4%	127,403	27.3%
Drive to Work in Carpool	1,282	5.8%	5,628	5.9%	28,109	6.0%
Travel to Work by Public Transportation	13,311	59.7%	55,295	58.0%	266,354	57.0%
Drive to Work on Motorcycle	29	0.1%	88	0.1%	490	0.1%
Bicycle to Work	93	0.4%	589	0.6%	2,772	0.6%
Walk to Work	1,516	6.8%	6,547	6.9%	30,346	6.5%
Other Means	154	0.7%	460	0.5%	1,897	0.4%
Work at Home	357	1.6%	1,572	1.6%	9,565	2.0%
Daytime Demographics (2017)						
Total Businesses	1,054		3,905		25,947	
Total Employees	10,528		40,137		227,065	
Company Headquarter Businesses	-	-	7	0.2%	55	0.2%
Company Headquarter Employees	-	-	3,222	8.0%	13,149	5.8%
Employee Population per Business	10.0 to 1		10.3 to 1		8.8 to 1	
Residential Population per Business	40.8 to 1		48.3 to 1		35.1 to 1	
Adj. Daytime Demographics Age 16 Years or Over	24,350		100,857		508,526	
Labor Force						
Labor Population Age 16 Years or Over (2017)	35,966		154,912		746,860	
Labor Force Total Males (2017)	17,197	47.8%	75,890	49.0%	367,430	49.2%
Male Civilian Employed	12,085	70.3%	52,435	69.1%	260,869	71.0%
Male Civilian Unemployed	460	2.7%	1,927	2.5%	10,053	2.7%
Males in Armed Forces	7	-	11	-	92	-
Males Not in Labor Force	4,645	27.0%	21,517	28.4%	96,416	26.2%
Labor Force Total Females (2017)	18,769	52.2%	79,022	51.0%	379,430	50.8%
Female Civilian Employed	10,052	53.6%	41,739	52.8%	204,417	53.9%
Female Civilian Unemployed	411	2.2%	1,641	2.1%	9,036	2.4%
Females in Armed Forces	-	-	7	-	22	-
Females Not in Labor Force	8,306	44.3%	35,635	45.1%	165,955	43.7%
Unemployment Rate		2.4%		2.3%		2.6%
Labor Force Growth (2010-2017)	-68	-0.3%	31	-	45	-
Male Labor Force Growth (2010-2017)	-29	-0.2%	21	-	25	-
Female Labor Force Growth (2010-2017)	-38	-0.4%	10	-	21	-
Occupation (2015)						
Occupation Population Age 16 Years or Over	22,205		94,142		465,240	
Occupation Total Males	12,114	54.6%	52,414	55.7%	260,844	56.1%
Occupation Total Females	10,090	45.4%	41,728	44.3%	204,396	43.9%
Management, Business, Financial Operations	2,854	12.9%	11,257	12.0%	58,054	12.5%
Professional, Related	4,706	21.2%	17,129	18.2%	91,747	19.7%
Service	5,705	25.7%	26,445	28.1%	119,888	25.8%
Sales, Office	4,729	21.3%	20,636	21.9%	99,878	21.5%
Farming, Fishing, Forestry	8	-	46	-	340	0.1%
Construction, Extraction, Maintenance	1,293	5.8%	7,109	7.6%	40,404	8.7%
Production, Transport, Material Moving	2,909	13.1%	11,520	12.2%	54,929	11.8%
White Collar Workers	12,289	55.3%	49,022	52.1%	249,678	53.7%
Blue Collar Workers	9,916	44.7%	45,120	47.9%	215,562	46.3%

This report was produced using data from private and government sources deemed to be reliable. The information herein is provided without representation or warranty.

COMPLETE PROFILE

2000-2010 Census, 2017 Estimates with 2022 Projections

Calculated using Weighted Block Centroid from Block Groups



Metro Commercial & Business Brokers, Inc.

Lat/Lon: 40.7347/-73.8735

RFULL9

89-25 Queens Blvd

Elmhurst, NY 11373

0.5 mi radius

1 mi radius

3 mi radius

Units In Structure (2015)

	0.5 mi radius	1 mi radius	3 mi radius
Total Units	14,054	61,241	310,348
1 Detached Unit	2,184 15.5%	8,355 13.6%	45,043 14.5%
1 Attached Unit	965 6.9%	4,434 7.2%	24,144 7.8%
2 Units	2,442 17.4%	10,536 17.2%	61,910 19.9%
3 to 4 Units	2,393 17.0%	8,732 14.3%	41,404 13.3%
5 to 9 Units	905 6.4%	3,449 5.6%	23,195 7.5%
10 to 19 Units	596 4.2%	2,491 4.1%	14,674 4.7%
20 to 49 Units	1,313 9.3%	7,212 11.8%	38,189 12.3%
50 or More Units	3,787 26.9%	18,124 29.6%	73,117 23.6%
Mobile Home or Trailer	26 0.2%	103 0.2%	641 0.2%
Other Structure	27 0.2%	29 -	46 -

Homes Built By Year (2015)

	0.5 mi radius	1 mi radius	3 mi radius
Homes Built 2014 or later	10 0.1%	52 0.1%	259 0.1%
Homes Built 2010 to 2013	165 1.2%	502 0.8%	2,230 0.7%
Homes Built 2000 to 2009	496 3.5%	1,535 2.5%	9,519 3.1%
Homes Built 1990 to 1999	713 5.1%	2,205 3.6%	8,569 2.8%
Homes Built 1980 to 1989	624 4.4%	2,646 4.3%	10,717 3.5%
Homes Built 1970 to 1979	1,350 9.6%	5,036 8.2%	19,141 6.2%
Homes Built 1960 to 1969	2,829 20.1%	11,771 19.2%	45,500 14.7%
Homes Built 1950 to 1959	2,856 20.3%	12,578 20.5%	61,217 19.7%
Homes Built 1940 to 1949	2,186 15.6%	11,240 18.4%	54,349 17.5%
Homes Built Before 1939	3,398 24.2%	15,904 26.0%	110,870 35.7%
Median Age of Homes	57.4 yrs	59.4 yrs	62.4 yrs

Home Values (2015)

	0.5 mi radius	1 mi radius	3 mi radius
Owner Specified Housing Units	4,919	19,529	108,511
Home Values \$1,000,000 or More	237 4.8%	861 4.4%	5,068 4.7%
Home Values \$750,000 to \$999,999	785 16.0%	2,635 13.5%	14,123 13.0%
Home Values \$500,000 to \$749,999	1,573 32.0%	6,313 32.3%	35,297 32.5%
Home Values \$400,000 to \$499,999	646 13.1%	2,877 14.7%	17,706 16.3%
Home Values \$300,000 to \$399,999	549 11.2%	2,169 11.1%	13,052 12.0%
Home Values \$250,000 to \$299,999	319 6.5%	1,238 6.3%	6,270 5.8%
Home Values \$200,000 to \$249,999	396 8.0%	1,449 7.4%	7,683 7.1%
Home Values \$175,000 to \$199,999	115 2.3%	505 2.6%	2,507 2.3%
Home Values \$150,000 to \$174,999	155 3.1%	733 3.8%	3,333 3.1%
Home Values \$125,000 to \$149,999	53 1.1%	303 1.6%	1,203 1.1%
Home Values \$100,000 to \$124,999	107 2.2%	442 2.3%	2,234 2.1%
Home Values \$90,000 to \$99,999	11 0.2%	63 0.3%	268 0.2%
Home Values \$80,000 to \$89,999	6 0.1%	43 0.2%	238 0.2%
Home Values \$70,000 to \$79,999	11 0.2%	28 0.1%	187 0.2%
Home Values \$60,000 to \$69,999	12 0.2%	67 0.3%	326 0.3%
Home Values \$50,000 to \$59,999	15 0.3%	59 0.3%	409 0.4%
Home Values \$35,000 to \$49,999	29 0.6%	64 0.3%	395 0.4%
Home Values \$25,000 to \$34,999	10 0.2%	48 0.2%	309 0.3%
Home Values \$10,000 to \$24,999	23 0.5%	89 0.5%	589 0.5%
Home Values Under \$10,000	31 0.6%	119 0.6%	763 0.7%
Owner-Occupied Median Home Value	\$494,103	\$476,260	\$483,962
Renter-Occupied Median Rent	\$1,367	\$1,308	\$1,320

This report was produced using data from private and government sources deemed to be reliable. The information herein is provided without representation or warranty.

COMPLETE PROFILE

2000-2010 Census, 2017 Estimates with 2022 Projections

Calculated using Weighted Block Centroid from Block Groups



Metro Commercial & Business Brokers, Inc.

Lat/Lon: 40.7347/-73.8735

RFULL9

89-25 Queens Blvd

Elmhurst, NY 11373

0.5 mi radius

1 mi radius

3 mi radius

Total Annual Consumer Expenditure (2017)

Total Household Expenditure	\$820 M	\$3.41 B	\$18.6 B
Total Non-Retail Expenditure	\$445 M	\$1.85 B	\$10.1 B
Total Retail Expenditure	\$376 M	\$1.56 B	\$8.52 B
Apparel	\$29.2 M	\$121 M	\$661 M
Contributions	\$34.3 M	\$141 M	\$800 M
Education	\$31.5 M	\$129 M	\$720 M
Entertainment	\$45.9 M	\$190 M	\$1.04 B
Food and Beverages	\$122 M	\$508 M	\$2.75 B
Furnishings and Equipment	\$28.1 M	\$116 M	\$641 M
Gifts	\$20.1 M	\$82.8 M	\$464 M
Health Care	\$65.5 M	\$274 M	\$1.48 B
Household Operations	\$23.5 M	\$96.5 M	\$536 M
Miscellaneous Expenses	\$12.2 M	\$50.9 M	\$276 M
Personal Care	\$10.8 M	\$44.7 M	\$244 M
Personal Insurance	\$6.03 M	\$24.8 M	\$139 M
Reading	\$1.82 M	\$7.56 M	\$41.5 M
Shelter	\$169 M	\$703 M	\$3.84 B
Tobacco	\$5.06 M	\$21.4 M	\$113 M
Transportation	\$153 M	\$637 M	\$3.46 B
Utilities	\$62.5 M	\$262 M	\$1.41 B

Monthly Household Consumer Expenditure (2017)

Total Household Expenditure	\$4,689	\$4,478	\$4,811
Total Non-Retail Expenditure	\$2,543 54.2%	\$2,424 54.1%	\$2,609 54.2%
Total Retail Expenditures	\$2,147 45.8%	\$2,054 45.9%	\$2,202 45.8%
Apparel	\$167 3.6%	\$159 3.6%	\$171 3.6%
Contributions	\$196 4.2%	\$185 4.1%	\$207 4.3%
Education	\$180 3.8%	\$170 3.8%	\$186 3.9%
Entertainment	\$262 5.6%	\$250 5.6%	\$270 5.6%
Food and Beverages	\$697 14.9%	\$667 14.9%	\$710 14.8%
Furnishings and Equipment	\$161 3.4%	\$153 3.4%	\$166 3.4%
Gifts	\$115 2.5%	\$109 2.4%	\$120 2.5%
Health Care	\$374 8.0%	\$360 8.0%	\$383 8.0%
Household Operations	\$134 2.9%	\$127 2.8%	\$139 2.9%
Miscellaneous Expenses	\$70 1.5%	\$67 1.5%	\$71 1.5%
Personal Care	\$62 1.3%	\$59 1.3%	\$63 1.3%
Personal Insurance	\$34 0.7%	\$33 0.7%	\$36 0.7%
Reading	\$10 0.2%	\$10 0.2%	\$11 0.2%
Shelter	\$965 20.6%	\$922 20.6%	\$991 20.6%
Tobacco	\$29 0.6%	\$28 0.6%	\$29 0.6%
Transportation	\$876 18.7%	\$836 18.7%	\$895 18.6%
Utilities	\$357 7.6%	\$344 7.7%	\$364 7.6%

This report was produced using data from private and government sources deemed to be reliable. The information herein is provided without representation or warranty.